

# Dell™ OptiPlex™ 580

## Setup and Features Information

### Mini Tower — Front and Back View

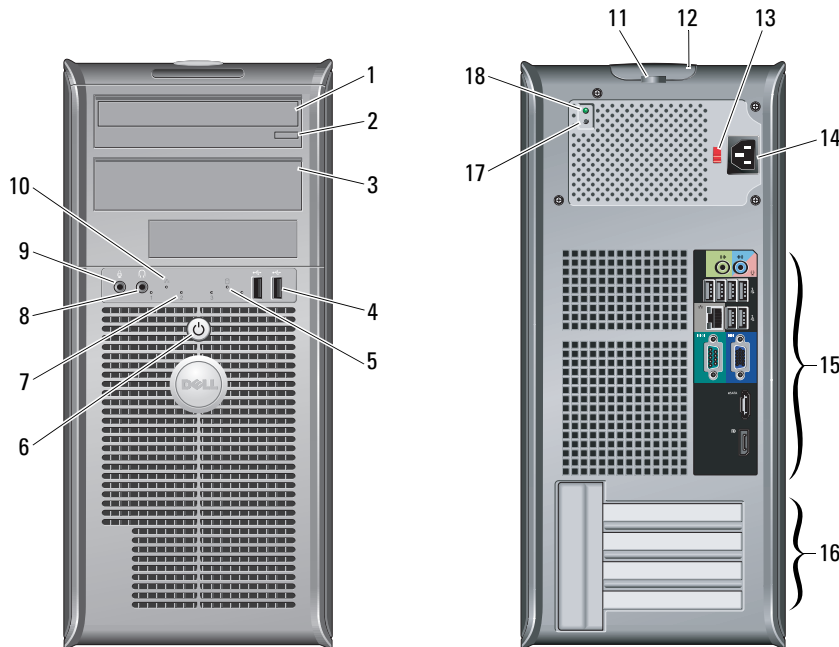

## About Warnings



**WARNING:** A WARNING indicates a potential for property damage, personal injury, or death.

- 1 optical drive
- 2 optical drive eject button
- 3 optical drive panel
- 4 USB 2.0 connectors (2)
- 5 drive activity light
- 6 power button, power light
- 7 diagnostic lights (4)
- 8 headphone connector
- 9 microphone connector
- 10 network connectivity light
- 11 padlock ring
- 12 cover-release latch, security cable slot
- 13 voltage selector switch
- 14 power cable connector
- 15 back panel connectors
- 16 expansion card slots (4)
- 17 power supply diagnostic button
- 18 power supply diagnostic light



**NOTE:** The voltage selector switch is available only on non-EPA power supplies.



Regulatory Models: D08M series, D04D series, and D02S series  
Regulatory Types: D08M001, D04D001, and D02S001

January 2010



078N8WA00

### Desktop — Front and Back View

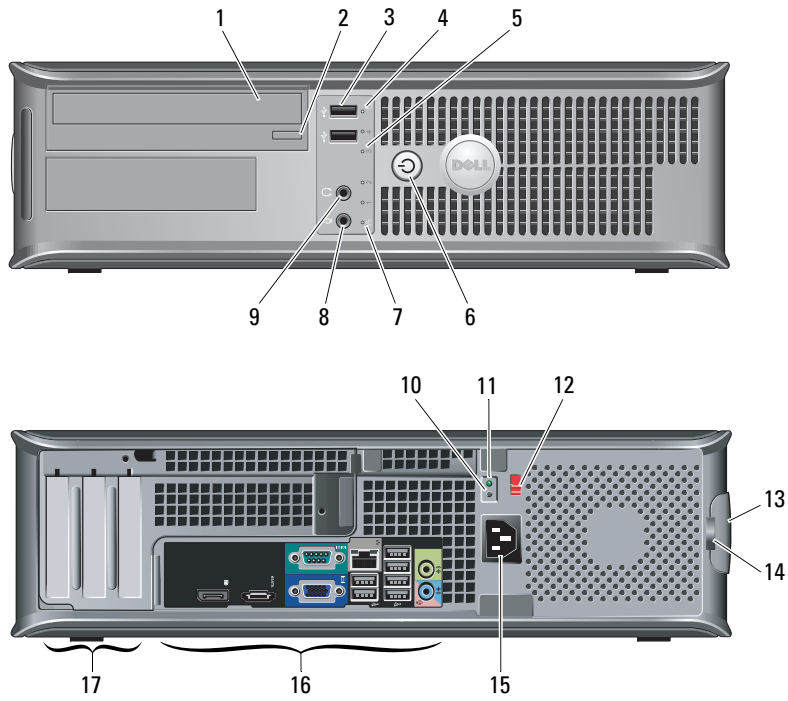

- 1 optical drive
- 2 optical drive eject button
- 3 USB 2.0 connectors (2)
- 4 drive activity light
- 5 diagnostic lights (4)
- 6 power button, power light
- 7 network connectivity light
- 8 microphone connector
- 9 headphone connector
- 10 power supply diagnostic button
- 11 power supply diagnostic light
- 12 voltage selector switch
- 13 cover-release latch, security cable slot
- 14 padlock ring
- 15 power cable connector
- 16 back panel connectors
- 17 expansion card slots (3)

**NOTE:** The voltage selector switch is available only on non-EPA power supplies.

### Small Form Factor — Front and Back View

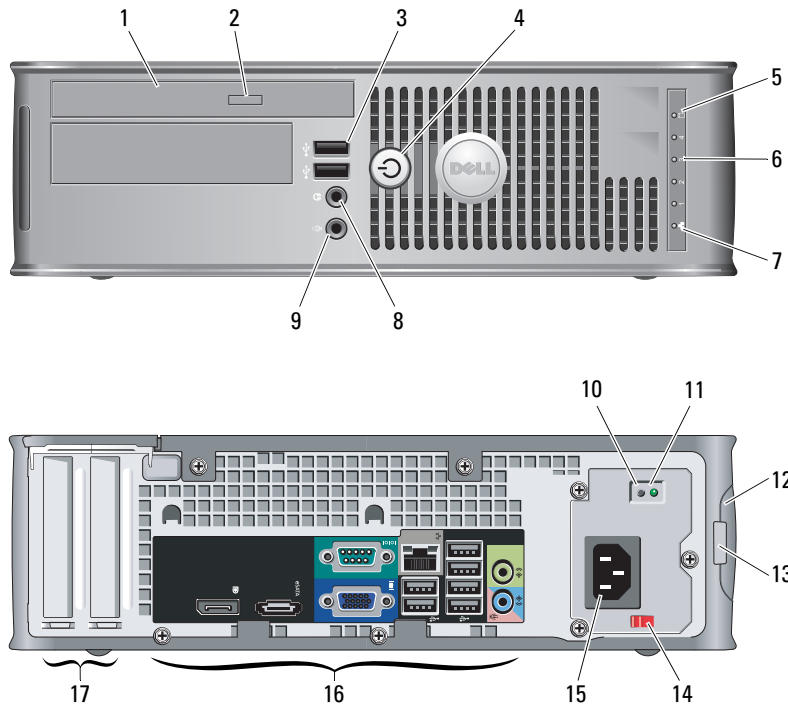

- 1 optical drive
- 2 optical drive eject button
- 3 USB 2.0 connectors (2)
- 4 power button, power light
- 5 drive activity light
- 6 diagnostic lights (4)
- 7 network connectivity light
- 8 headphone connector
- 9 microphone connector
- 10 power supply diagnostic button
- 11 power supply diagnostic light
- 12 cover-release latch, security cable slot
- 13 padlock ring
- 14 voltage selector switch
- 15 power cable connector
- 16 back panel connectors
- 17 expansion card slots (2)

**NOTE:** The voltage selector switch is available only on non-EPA power supplies.

### Mini Tower, Desktop, and Small Form Factor — Back Panel

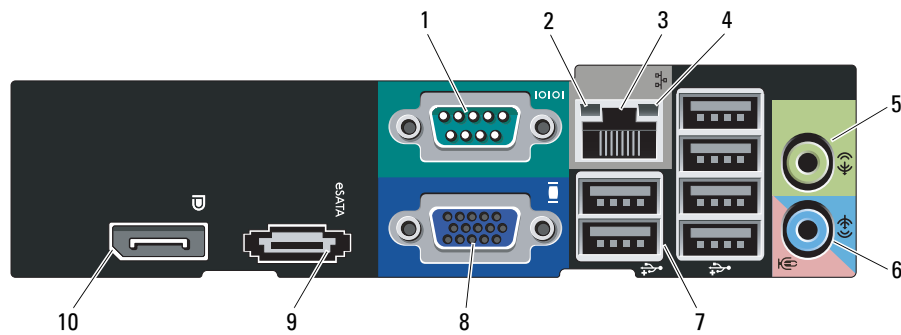

- 1 serial connector
- 2 link integrity light
- 3 network adapter connector
- 4 network activity light
- 5 line-out connector
- 6 line-in/microphone connector
- 7 USB 2.0 connectors (6)
- 8 VGA connector
- 9 eSATA connector
- 10 DisplayPort connector

## Quick Setup

**⚠ WARNING:** Before you begin any of the procedures in this section, read the safety information that shipped with your computer. For additional best practices information, see [www.dell.com/regulatory\\_compliance](http://www.dell.com/regulatory_compliance).

**📎 NOTE:** Some devices may not be included if you did not order them.

**1** Connect the monitor using only one of the following cables:

**a** The blue VGA cable.

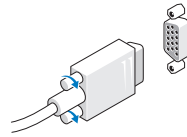

**b** The DisplayPort cable.

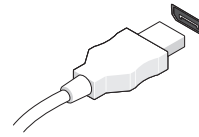

**2** Connect the network cable (optional).

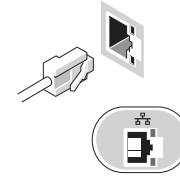

**3** Connect the modem (optional).

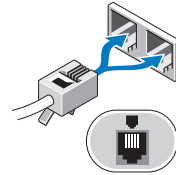

**4** Connect the USB keyboard or mouse (optional).

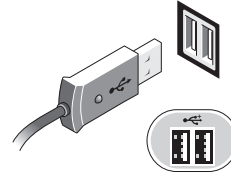

**5** Connect the power cable(s).

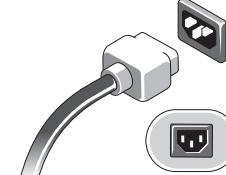

**6** Press the power button on the monitor and the computer.

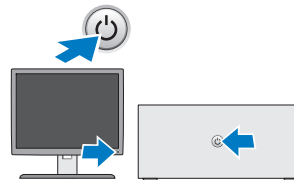
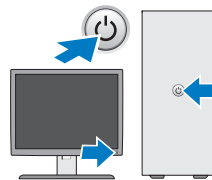

## Specifications

 **NOTE:** The following specifications are only those required by law to ship with your computer. For a complete and current listing of the specifications for your computer, go to [support.dell.com](http://support.dell.com).

### System Information

Chipset	AMD 785G chipset (RS880 + SB710)
Processor	<ul style="list-style-type: none"> <li>• AMD Phenom II</li> <li>• AMD Athlon II</li> <li>• AMD Sempron</li> </ul>

### Video

Video type:	
Integrated	ATI Radeon™ HD 4200 Graphics
Discrete	PCI Express 2.0 x16 Graphics Adapter
	<b>NOTE:</b> BIOS default setting is PCI Express x8 + DisplayPort (DP), DP will be automatically disabled while configuring GFX/Display Port as PCI Express x16.
Video memory:	
Integrated	Up to 512 MB shared video memory (system memory greater than 1536 MB)

### Memory

Memory module connector	Four DIMM slots
Memory module capacity	1 GB, 2 GB, or 4 GB
Memory type	1066 MHz DDR3 SDRAM (non-ECC only)
Minimum memory	1 GB
Maximum memory	16 GB

### Drives

	Mini Tower	Desktop	Small Form Factor
Externally accessible:			
5.25 inch drive bays	two	one	one (slimline)
Internally accessible:			
3.5 inch SATA drive bays	two	one	one
Available devices:			
2.5-inch SATA hard drive (with brackets)	two	two	two
3.5 inch SATA hard drives	two	one	one
5.25 inch SATA DVD-ROM, DVD/CD-RW Combo, or DVD+/-RW drives	two	one	one (slimline)

**NOTE:** 3.5" HDDX1 + 2.5" HDD X2 + 5.25" ODD X1 combination of drive bays is not supported in a OptiPlex 580 Small Form Factor computer.

**Control Lights and Diagnostic Lights**

Power button light	Green light — Solid green light indicates power-on state; blinking green light indicates sleep state of the computer. Amber light — Solid amber light when the computer does not start indicates a problem with the system board or power supply. Blinking amber light indicates a problem with the system board.
Drive activity light	Displays the SATA hard drive or optical drive activity. Green light — Blinking green light indicates that the computer is reading data from, or writing data to, from the drive.
Network connectivity light	Green light — A good connection exists between the network and the computer. Off (no light) — The computer is not detecting a physical connection to the network.
Diagnostic lights	Four lights located on the front/back panel of the computer. For information on the diagnostic lights, see the <i>Service Manual</i> available on the Dell Support website at <a href="http://support.dell.com/manuals">support.dell.com/manuals</a> .

Power	Wattage	Maximum heat dissipation	Voltage
Mini Tower			
Non-EPA	305 W	1041 (BTU/hr.)	100-240 VAC, 50/60 Hz, 3.6/1.8 A
EPA	255 W	1041 (BTU/hr.)	100-240 VAC, 50/60 Hz, 3.6/1.8 A
Desktop			
Non-EPA	255 W	955 (BTU/hr.)	115/230 VAC, 50/60 Hz, 4.0/2.0 A
EPA	255 W	955 (BTU/hr.)	115/230 VAC, 50/60 Hz, 4.0/2.0 A
Small Form Factor			
Non-EPA	235 W	938 (BTU/hr.)	115/230 VAC, 50/60 Hz, 3.5/1.8 A
EPA	235 W	938 (BTU/hr.)	115/230 VAC, 50/60 Hz, 3.5/1.8 A
<b>NOTE:</b> Heat dissipation is calculated by using the power supply wattage rating.			
Coin-cell battery	3 V CR2032 lithium coin cell		

<b>Physical</b>	Mini Tower	Desktop	Small Form Factor
Height	40.8 cm (16.1 inches)	11.4 cm (4.5 inches)	9.3 cm (3.7 inches)
Width	18.7 cm (7.4 inches)	39.9 cm (15.7 inches)	31.4 cm (12.4 inches)
Depth	43.3 cm (17.0 inches)	35.3 cm (13.9 inches)	34.0 cm (13.4 inches)
Weight (Minimum)	11.7 kg (25.8 lb)	8.26 kg (18.2 lb)	6.8 kg (15.0 lb)
<b>Environmental</b>			
Temperature:			
Operating	10° to 35°C (50° to 95°F)		
Storage	-40° to 65°C (-40° to 149°F)		
Relative humidity	20% to 80% (noncondensing)		
Altitude:			
Operating	-15.2 to 3048 m (-50 to 10,000 ft)		
Storage	-15.2 to 10,668 m (-50 to 35,000 ft)		
Airborne contaminant level	G2 or lower as defined by ISA-S71.04-1985		

## Finding More Information and Resources

See the safety and regulatory documents that shipped with your computer and the regulatory compliance website at [www.dell.com/regulatory\\_compliance](http://www.dell.com/regulatory_compliance) for more information on:

- Safety best practices
- Warranty
- Terms and Conditions
- Regulatory certification
- Ergonomics
- End User License Agreement

**Information in this document is subject to change without notice.  
© 2010 Dell Inc. All rights reserved. Printed in the U.S.A.**

Reproduction of these materials in any manner whatsoever without the written permission of Dell Inc. is strictly forbidden.

Trademarks used in this text: *Dell*, the *DELL logo*, and *OptiPlex* are trademarks of Dell Inc.; *AMD*, *AMD Phenom*, *Athlon*, *Sempron*, *ATI Radeon* and combinations thereof are trademarks of Advanced Micro Devices, Inc.

Other trademarks and trade names may be used in this document to refer to either the entities claiming the marks and names or their products. Dell Inc. disclaims any proprietary interest in trademarks and trade names other than its own.