



Sign in



Explore

Shop

Support



Sign in

Support Home

Products

Software and Drivers

Diagnostics

Contact Us

Business Support

My HP Account

HP and Compaq Desktop PCs - Motherboard Specifications, 532 (Glendale)

Powered by HP Support Assistant



Having PC issues?

TRY OUR DIAGNOSTICS SOLUTIONS TO FIX ISSUES QUICKLY

CLICK HERE



Information

NOTE: If you are searching for the Pavilion 533w motherboard specifications, check the serial number located on the back of the PC. This is the correct document for serial numbers starting with a **KR** or **CH**. For serial numbers starting with a **MX**, [click here for the correct motherboard document.](#)

FEATURE/SPECIFICATION	DESCRIPTION
Motherboard Description	<ul style="list-style-type: none"> Manufacturer's name - Trigem GL VE 2002052 HP/Compaq name - Glendale
Motherboard supplier	Trigem
System BIOS supplier	Phoenix
Form factor	uATX



FEATURE/SPECIFICATION	DESCRIPTION
Processor brand	Intel
Processor socket type	mPGA478
Processor family	P4 and Celeron (Willamette, Northwood)
Processor	2.5 GHz Intel Pentium 4
Processor	400 MHz
Processor	845GL
Chipset "North Bridge"	845GL
Revision/stepping	A1
Chipset "South Bridge"	ICH4
Revision/stepping	A1
Super I/O	SMsC LPC47M102
Revision/stepping	VS142AV

✕

 Powered by
HP Support Assistant



Having PC issues?

TRY OUR DIAGNOSTICS
SOLUTIONS TO FIX ISSUES
QUICKLY

[CLICK HERE](#)



FEATURE/SPECIFICATION	DESCRIPTION
Flash BIOS device	2 DIMMs (184 Pin)
Memory type	DDR
Memory speed	PC2100/PC1600
Memory configuration	2 DIMMs (184 Pin)
Memory size	2 GB (HP and Compaq recommend 1 GB)
Memory brand	Intel
Graphics configuration	Down, In Chipset
Onboard graphics memory	UMA/up to 48 MB
Graphics connector (AGP)	None
TV-Out device	No
TV-Out configuration	ADD TV-out card
Audio	AC'97 Down

✕

 Powered by HP Support Assistant



Having PC issues?

TRY OUR DIAGNOSTICS SOLUTIONS TO FIX ISSUES QUICKLY

[CLICK HERE](#)



FEATURE/SPECIFICATION	DESCRIPTION		
AC'97 CODEC device	ADI1981A		
Audio Jacks (Mic, Line-In, Line-Out, Speaker, MIDI/Game)	M,LI,LO,SO		
Ethernet 10/100 LAN controller	Realtek RTL8100(B)		
PCI, Down	PCI, Down		
ATA-66/100	ATA-66/100		
6	6		
USB Front/Back options	2F+4B		
Serial, Parallel, Floppy, PS2 Kbd and Mouse	1S, 1P, 1F, PS2 K+M		
Serial Port Front Chassis option	No		
Available Mfg options	-G, L, A		
Available Mfg options (legend below)			
<table border="1"> <tr> <td data-bbox="24 1921 121 2068">A</td> <td data-bbox="121 1921 812 2068">Audio down on motherboard</td> </tr> </table>	A	Audio down on motherboard	
A	Audio down on motherboard		

 Powered by
 HP Support Assistant
 ×



Having PC issues?
TRY OUR DIAGNOSTICS SOLUTIONS TO FIX ISSUES QUICKLY

[CLICK HERE](#)



FEATURE/SPECIFICATION		DESCRIPTION
C	External L2 cache on motherboard	
E	1394 on motherboard	
G	Graphics down (on motherboard or in chipset)	
	(Ethernet) P - PCMCIA slot	
	ent support	
	ard	
U	Graphics card (up, not on motherboard)	
W	Microsoft® Windows XP hardware compliant	

Layout and Photographs

Figure 1: Layout



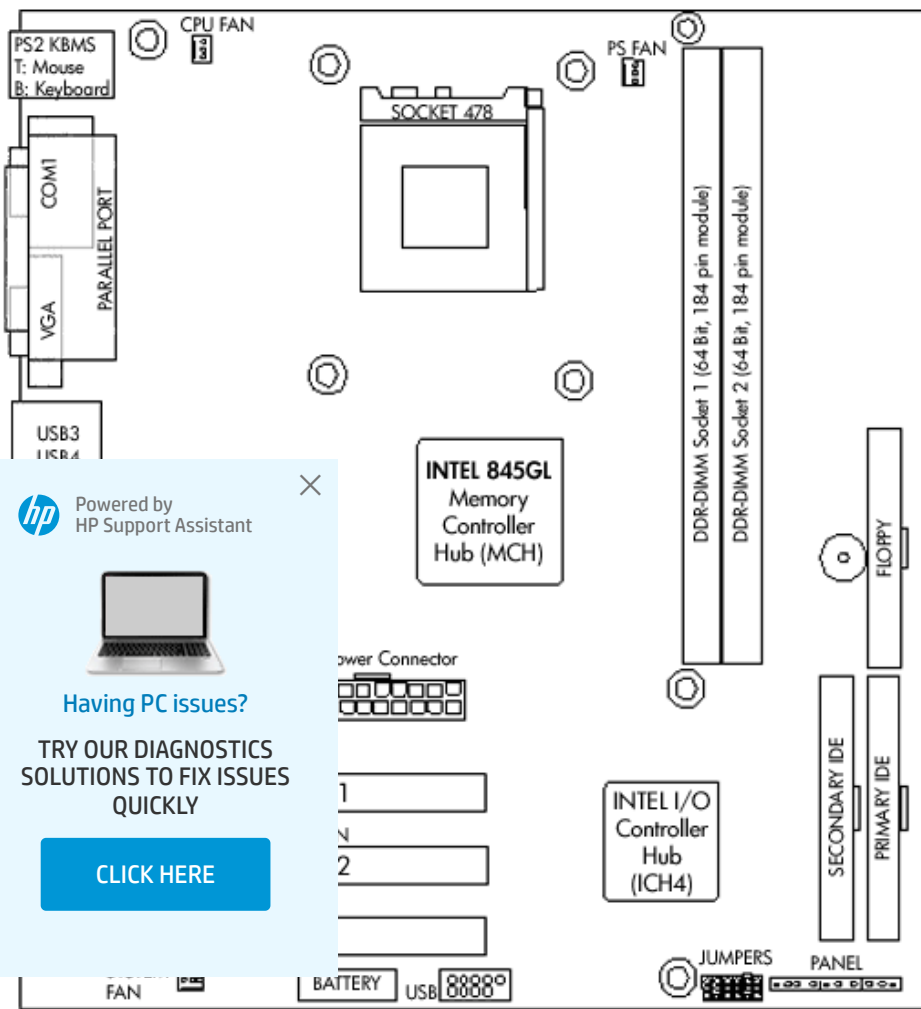
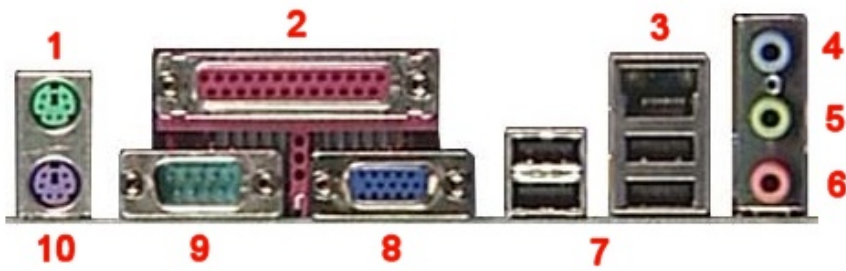



Figure 2: Photograph





1. Mouse
2. Parallel
3. LAN
4. Line-in

Powered by HP Support Assistant



Having PC issues?

TRY OUR DIAGNOSTICS SOLUTIONS TO FIX ISSUES QUICKLY

[CLICK HERE](#)

BIOS settings

The jumper allows you to clear the Real Time Clock (RTC) RAM in CMOS. It also allows clearing of date, time, and BIOS settings in CMOS by erasing the RTC RAM data. The onboard button cell battery powers the RAM data in CMOS, such as system passwords.

CAUTION: Do not change any jumper setting while the computer is on. Damage to the motherboard can result.

1. Turn off the PC and unplug the power cord.
2. Move the J4 jumper cap from pins 1-2 (normal) to pins 2-3 (clear CMOS).
3. Keep the J4 jumper cap on pins 2-3 for 6 seconds, then move it back to pins 1-2.
4. Plug in the power cord and turn on the PC.

Clearing the BIOS password

The BIOS password protects the BIOS from undesired changes. If password checking is enabled, and you need to disable it, use the following steps:

CAUTION: Do not change any jumper setting while the computer is on. Damage to the motherboard can result.

1. Turn off the PC and unplug the power cord.
2. Move the J2 jumper cap from pins 1-2 to pins 2-3, to enter the BIOS without a password.
3. To enter BIOS setup, start the PC and press $\text{F}1$ as the PC boots.
4. Clear or reset the BIOS password.
5. Save the BIOS settings and turn off the PC.
6. Return the J2 jumper cap to pins 1-2.



hp Powered by HP Support Assistant



Having PC issues?

TRY OUR DIAGNOSTICS SOLUTIONS TO FIX ISSUES QUICKLY

CLICK HERE



Ask a question on our HP Support Community page

Go now



Get in touch with one of our support agents

Contact us

Country/Region: South Africa ▲

About Us

- Contact HP
- Careers
- Investor relations
- Sustainable impact
- Press center
- The Garage

Ways to buy

- Call an HP rep
- Find a reseller
- How to buy

Support

- Download drivers
- Support & troubleshooting
- Community
- Register your product
- Check repair status
- Training & certification

HP Partners

- HP Amplify Partner Program
- HP Partner Portal
- Developers

Stay Connected



 Powered by
HP Support Assistant



Having PC issues?

TRY OUR DIAGNOSTICS
SOLUTIONS TO FIX ISSUES
QUICKLY

[CLICK HERE](#)

